

## Data Sheet

# Flexi-load High Performance DPC

Polymer engineered High Performance DPC with a unique embossed surface. Tough, flexible and suitable for cavity trays

### Application

- Supplied on 20m rolls in width ranges from 100mm to 1000mm
- To be used as a flexible cavity tray system
- Site formed to manage the downward passage of water.
- To prevent the passage of moisture from the ground rising into the fabric of the building.
- Can be used in heavy loading situations, such as in multi storey buildings

### Product Features & Benefits

- Contains no hazardous pitch or bitumen
- Will not extrude under load
- Outstanding puncture and tear resistance
- Embossed to increase adhesion and reduce slippage
- Flexible at low temperatures
- Available in a range of standard widths
- CE Marked to EN 14909
- Conforms to BS8215 and PD6697
- Radon resistant damp proof course
- Preformed Units available

### Materials

- Colour - Black
- Thickness - 0.8mm
- Roll sizes - various widths x 20mtr
- CE Marked to EN 14909

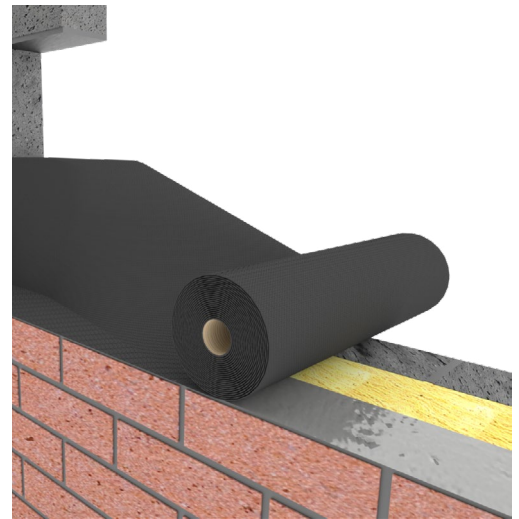

## Technical Background

The Flexi-load range of polymeric DPCs are a well-established range of damp proof courses and accessories, designed to meet the increasing demands of the construction market. They are tough and flexible and perform well under high compressive loads.

## Installation Guide

- Follow good practice and relevant clauses as set out in BS8000-3, BS8215 & PD6697
- Flexi-load must extend through the full thickness of the wall, including pointing, applied rendering or other facing material.
- Ground floor dpc's in external walls should be laid a minimum of 150mm above the adjacent ground level.
- Flexi-load must be laid on a fresh, even bed of mortar central to the mortar joint and never dry bedded.
- All lap joints must have a minimum 100mm overlap and be completely sealed with our LT jointing tape.
- Rigid preformed junction units can aid supporting joints



## Product Range Accessories

- Our Technical Department is available to advise on individual projects and to prepare or assist in the preparation of schedules and issue drawings.
- Flexi-Load high performance DPC in various roll widths

Description	Roll width	Length	Thickness	m <sup>2</sup> /roll
Flexi-load high performance DPC	100mm	20m	0.8mm	2
Flexi-load high performance DPC	112mm	20m	0.8mm	2.24
Flexi-load high performance DPC	150mm	20m	0.8mm	3
Flexi-load high performance DPC	225mm	20m	0.8mm	4.5
Flexi-load high performance DPC	300mm	20m	0.8mm	6
Flexi-load high performance DPC	337.5mm	20m	0.8mm	6.75
Flexi-load high performance DPC	450mm	20m	0.8mm	9
Flexi-load high performance DPC	600mm	20m	0.8mm	12
Flexi-load high performance DPC	900mm	20m	0.8mm	18
Flexi-load high performance DPC	1000mm	20m	0.8mm	20

- Pre-formed corners units – for use to return corners for full perimeter cavity tray.

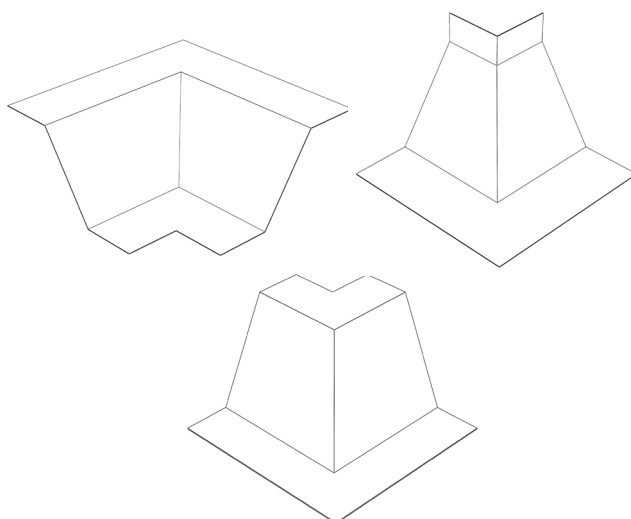
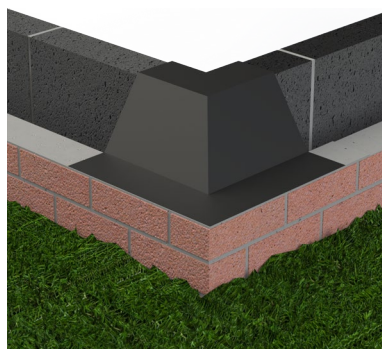

- Pre-formed change in level & stepped units - for use where a cavity tray must step up or down to follow ground level

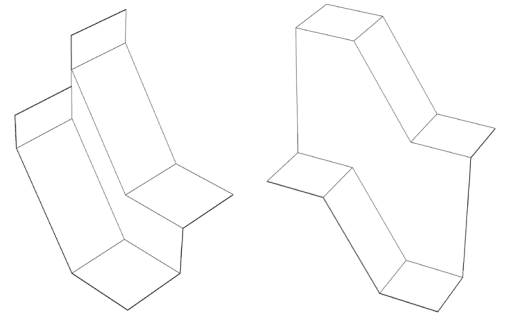
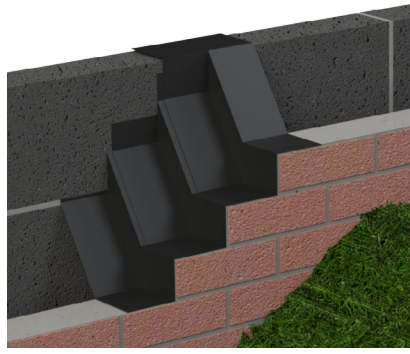
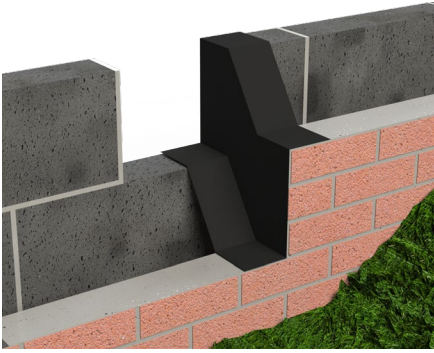

- Pre-formed Telescopic underfloor vent collars – To allow for sealing around ventilation ducts.

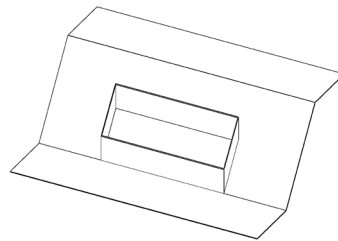
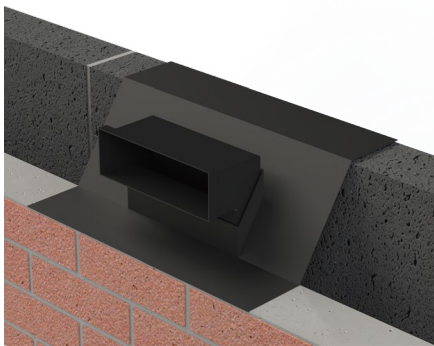

- Pre-formed stop end units - for capping off the ends of a cavity tray run and at column projections

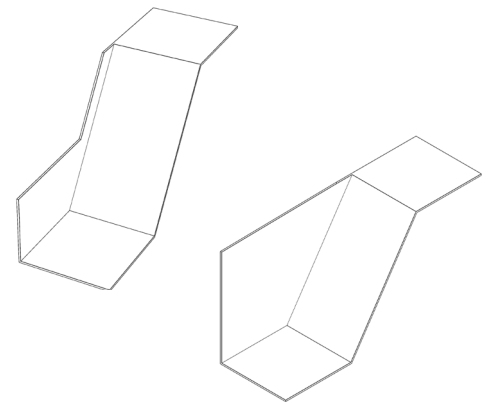
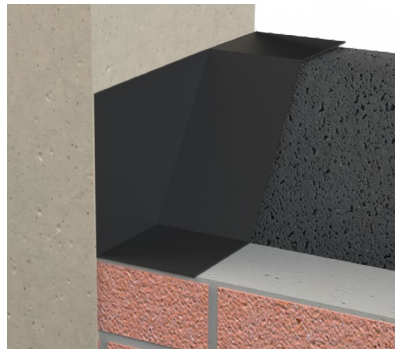
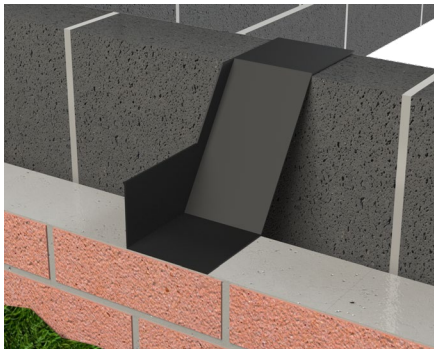

- Lintel stopends - To close off cavity trays above openings

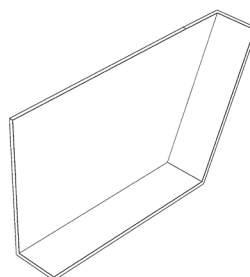
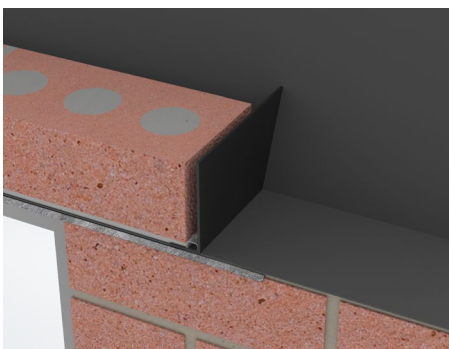

- Preformed column cloaks – for capping column projections that reduce clear cavity size

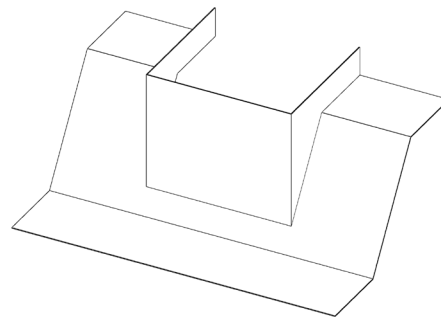

- Special tailor-made accessories are available to order including Windposts and I Beam cloaks

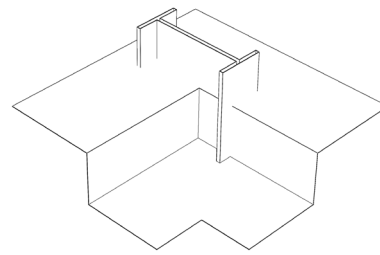
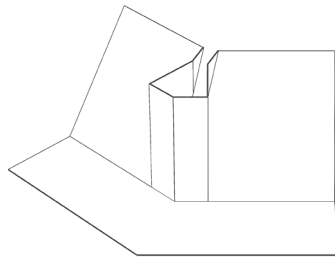
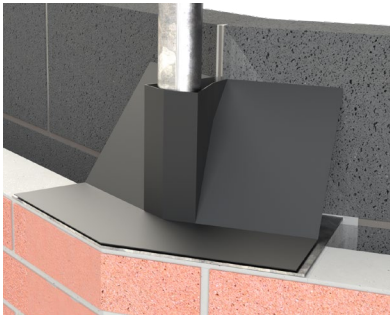

- HifloWeep Wall Weep – for cavity drainage, fitted at regular 900mm centres for linear DPC cavity trays and/or 450mm centres for above openings.

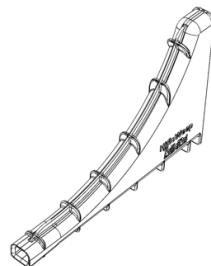
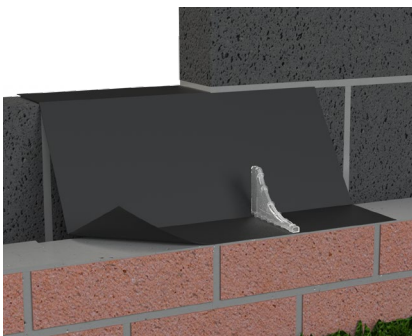

- DPC fixing strip is an easy to handle and use semi flexible plastic PVCu strip 30mm x 2m (packed in 50's) for securing upstands to flexible DPC's by offering uniform retention with additional mechanical fixings (not supplied) via the pre-drilled 4mm holes at 150mm centres.

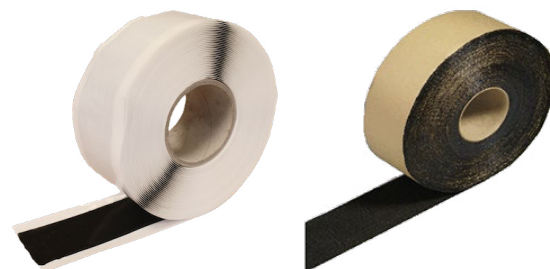
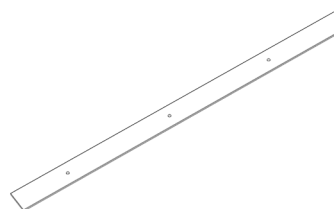
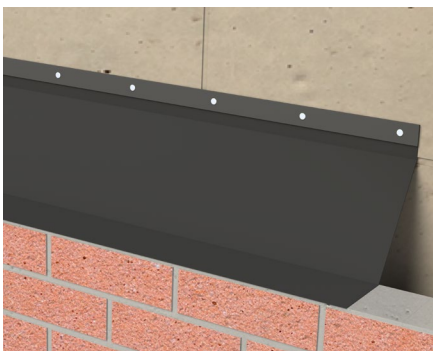

- LT Jointing strip tape and Reinforced detail strip - for sealing lapped joints in the dpc and/or for sealing to accessories.